Instruction for use and maintenance

Anchorage Device „Söll-MultiRail“ horizontal

closed glider complying with DIN EN 795

Part-No. 17407

Serial number: _____

Year of manufacture: _____

Date of

purchase: _____

(The following must be completed by the operator in permanent waterproof ink.)

Date of initial operation: _____

Operator/user: _____

Street: _____

Place: _____

Phone: _____

Fax: _____

Issue: 04.08.2009

SE 26



Table of content

	Page
A Safety precautions	3
B Checking before use	4
C Using the runner	5
D Maintenance	8
E Storage	12
F Care	12

These instructions are protected by copyright!

They may not be reproduced and distributed in any ways/ by any means without prior written consent of the author according to

Articles 16 and 17 of the German Copyright Act.

Honeywell Fall Protection Deutschland GmbH & Co. KG
will prosecute any violations against this under Article 106
of the German Copyright Act.

In this issue the following has been changed: logotype

A Safety precautions

- A 1. These instructions must be brought to the attention of any person using the „Söll-MultiRail“ system before he begins to use the system. Actions contravening these instructions may endanger the safety of the User!
- A 2. The owner of the Söll- "Söll-MultiRail“ anchorage device must ensure that these instructions are:
- retained in a dry and secure condition at the installation or
 - retained by the operator, whereby he must ensure that the user is aware of the storage location of these instructions and that the documents and that they are anytime easily available.
- A 3. The operator must be able to present these instructions to the manufacturer of the SÖLL - system; (Honeywell Fall Protection Deutschland GmbH & Co. KG or one of its authorized dealers) upon request. These instructions must be enclosed when returning in the "Söll-MultiRail runner".
- A 4. The respective instructions must be observed when assembling, installing or using Söll accessories with this Söll „Söll-MultiRail runner“.
- A 5. The respective instructions must be observed when using other personal protection equipment.
- A 6. The "Söll-MultiRail runner" is part of the Söll „Söll-MultiRail“ system and as personal safety equipment has been designed only for correct use with the Söll Söll-MultiRail system.
- A 7. Söll „Söll-MultiRail runners" may only be fitted and operated with original Söll components / elements. **Combining with components and/or elements from other manufacturers can adversely affect the safety of the Söll „Söll-MultiRail“ system. In these situations Söll GmbH and their dealers will reject any claims for product liability!**
- In addition, such cases are completely unauthorised, as Söll runners are tested and certified as complete systems. Full liability is therefore transferred to the operator!
- A 8. The "Söll-MultiRail runner" may only be used with overhead "Söll-MultiRail" systems, appropriate connecting sub-system (e.g. lanyard or retractable fall arrester) and with full body harnesses according to EN 361.
- A 9. The runner should only be used in combination with EN 361 compliant safety harnesses.
- A 10. Before and during use the Söll „Söll-MultiRail runner“ must be subjected to visual checks for correct functioning of the system.
- A 11. For the operator's safety it is important that he is in proper state of health and that he is not under the influence of alcohol or drugs.
- A 12. The facility must include a rescue action plan considering all possible emergency cases which may occur during works.
- A 13. When the equipment is sold in another country, it is important for the safety of the user that the reseller provides him this manual in the corresponding language of the country concerned.

B Checking before use

- B 1. Ensure that the runner, safety harness, lanyard with a DIN EN 355 compliant fall arrestor, a fall arrestor or a travelling safety device as well as guide rails (= anchorage device) are in the flawless working condition and are functioning properly before and during their every use. Ensure that the device and the components are not deformed or damaged.
- B 2. The Söll „Söll-MultiRail“ system may not be used if there are any doubts regarding its safe use, if defects are visible, or if the device has been strained as a result of a fall. It may not be used until written permit is given by a specialist. If necessary, the "Söll-MultiRail runner" should be returned to the manufacturer.

Attention!

A specialist is not authorised to carry out repairs!

- B 3. Before each use, it has to be ensured that there is sufficient fall clearance beneath the operator, so that in case of a fall, he cannot strike the ground or against other obstacles.

C Using the runner

The Söll anchorage device should be used only by personnel who are trained to handle this device safely. Every user must use a separate runner!

Fit the EN 361 safety harness in accordance with the applicable instructions.

If using:

- a safety rope with EN 355 fall arrester, attach this to the back eyelet of the safety harness in accordance with the instructions.

Important!

The fall arrester must always be on the body side!

- a travelling fall arrester with flexible guide, use only equipment that the manufacturer has guaranteed will also function in the planned direction of strain.

Attention!

The runner is to be inserted in the guide rail and the user may attach to the runner only when he is in a position secured against falls. Before removing the runner or detaching from the lanyard, (safety line, guided type fall arrester) safety against falls has to be otherwise provided.

C 1. Mounting/removing the runner

Warning:

Before removing the runner from the guide rail, you must take other measures to ensure protection against falls.

1. Alternative

Use: Fixed end stop (Part-No. 17404)

Fig. 1

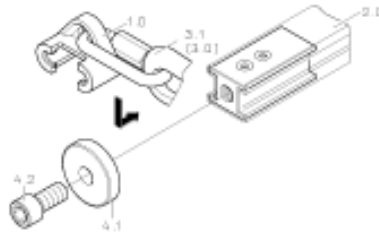

Remove the stop plate (4.1) by detaching the screw (4.2). Insert the runner (1.0) into the guide rail „Söll-MultiRail“ (2.0). Hereinafter, fix the stop plate (4.1) again by means of the screw (4.2), to avoid accidental gliding out of the runner. Now, the runner can be moved freely on the guide rail (1.1). To detach the runner, screw out the stop plate (4.1) and remove the runner from the rail. Finally, fix the stop plate again by means of the screw.

2. Alternative

Use: Rail end stop with exit (Part-No. 23956)

Fig. 2

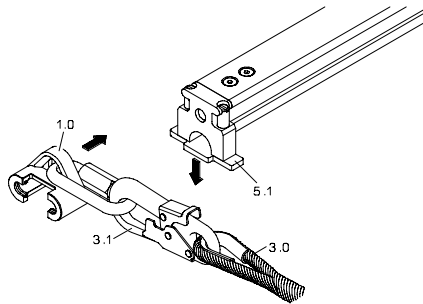

Press the unlocking plate (5.1) downwards with one hand and **place** the runner (1.0) onto the guide rail (2.0) with the other. The runner can now move freely on the guide rail (2.0).

While **detaching**, press the unlocking plate (5.1) downwards and pull the runner out from the rail.

Caution!

The unlocking plate (5.1) must be pressed to the initial position using spring force.

D Maintenance

- D 1. The regular maintenance of the "Söll-MultiRail runner" are to be performed considering the legal regulations, the conditions of use and environmental conditions. Maintenance must be performed by a competent person, at least once a year.

A competent person for the maintenance of this equipment is

a person suitably trained or qualified by knowledge and practical experience to enable the maintenance to be performed properly.

- D 2. Regular maintenance is essential as the safety of the operator depends from the effectiveness and durability of the equipment.

- D 3. **Maintenance checklist** (see fig.3)

The checklist has to be completed and signed by a competent person by means of an indelible pen. The single check points have to be marked respectively with "OK" or "D" (defect). The competent person is responsible for the accuracy of the information provided therein. Check points marked with a "D" can be corrected by a competent person only when the defect to be corrected concerns the removal of dirt (paint, mortar, concrete) or when markings need to be cleaned. This procedure must be noted in the annex of the check list (remarks), complete with date and signature of the competent person. The due date of the next regular inspection must also be indicated.

In case the correction of defects requires a partial disassembling of the components, the "Söll-MultiRail runner" must be returned to the manufacturer together with the manual and with a relevant comments concerning the defect.

Maintenance checklist, see Fig. 3

	1	2	3	4	5
Year					
Date					
Name of the specialist					
Signature					
Reason for the revision*					
Ext. Inspection is due					
Item 1					
Body (1.1)					
Free of dirty					
Marking well legible					
No relevant changes (i.e., due to a fall)					
Has no cracks in the body of the runner					
Item 2					
Suspension eyelet (1.2)					
Not bent					
Has no cracks					
Tensioning pin present					
Tensioning pin undamaged					
Item 3					
Polyamide-semi-circle (1.3)					
All 4 inlays present					
Wear-out limit (metal superficies rubs on the rail) not yet reached					
Not bent, i.e. due to a fall					

Further remarks

Further remarks

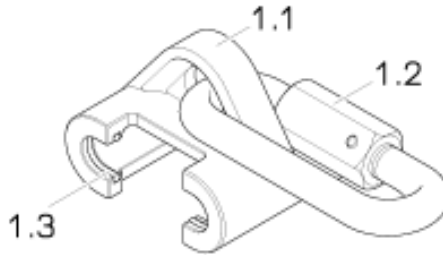
Fig. 3

E Storage

As the design of the runner is simple and without any movable parts, it can remain in the system without any problems.

F Care

Before inserting the runner or attaching the lanyard in the eyelet it must already be ascertained that the polyamide semi-circles (1.3) are not worn out. Also, if the runner remains in the system, this must be checked.