

Miller Inverted "L" Rigid Rail System

Description

The Miller Inverted "L" System is designed to work in a variety of applications such as truck tarping, truck or rail hatch opening/closing, rail loading/unloading, and vehicle and equipment maintenance applications. Miller harnesses and self-retracting lifelines should be purchased separately. This system includes a rebar cage assembly for the standard foundation. The end user is responsible for sourcing and constructing the concrete footing.

Materials

General Construction: Welded Steel
Finish: Polyurethane paint on structure, zinc plated fasteners, vinyl covers for anchor bolts

Technical

Max. Capacity: Two workers at 310 lbs. (141 kg) each;
 For FSLSPH - one worker at 310 lbs. (141 kg)

Design Factor: 2:1 for 900 lb. (4kN) maximum arresting force

Maximum Work Radius: 5 ft. (1.5 m)

Proof Load: 1,800 lb. (8kN) in direction of fall per worker

Coverage Options: 20 ft. (6.1 m), 40 ft. (12.2 m) and 60 ft. (18.3 m) lengths - coverage may vary depending on the application and available fall clearance

Compliance

Meets OSHA 1926.502, Subpart M requirements.

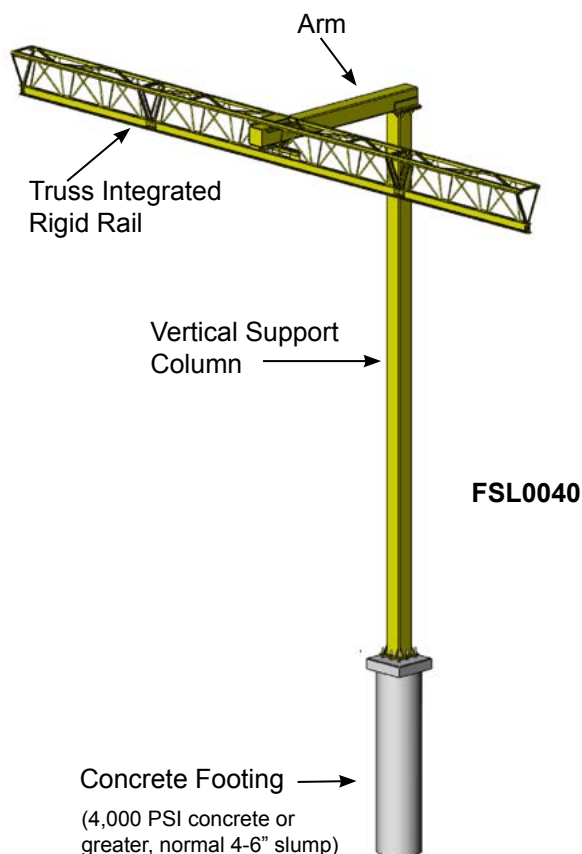

Part Number	Description	Height	Rail Length	Arm Length	Weight*
Inverted "L" System - Each system includes a tagline assist kit, providing the ability to store the tagline when not in use.					
FSL0020	Rigid rail system for up to two (2) workers with one beam trolley (additional beam trolley sold separately)	30 ft. (9.1 m)	19 ft. (5.8 m)	13 ft. (3.8 m)	2,475 lbs. (1,123 kg)
FSL0040	Rigid rail system for up to two (2) workers with one beam trolley (additional beam trolley sold separately)	32 ft. (8 m)	39 ft. (11.9 m)	12 ft. (3.7 m)	3,336 lbs. (1,513 kg)
FSL0060	Rigid rail system for up to (2) two workers with one beam trolley (additional beam trolley sold separately)	32 ft. (8 m)	57 ft. (16.5 m)	12 ft. (3.7 m)	3,936 lbs. (1,785 kg)
FSLSPH	Single point anchorage system (rigid rail not included)	30 ft. (9.1 m)	N/A	13 ft. (3.8 m)	1,875 lbs. (850 kg)

*Weight does not include concrete footing.

Miller Inverted "L" Rigid Rail System

FSL0040 Product Dimensions

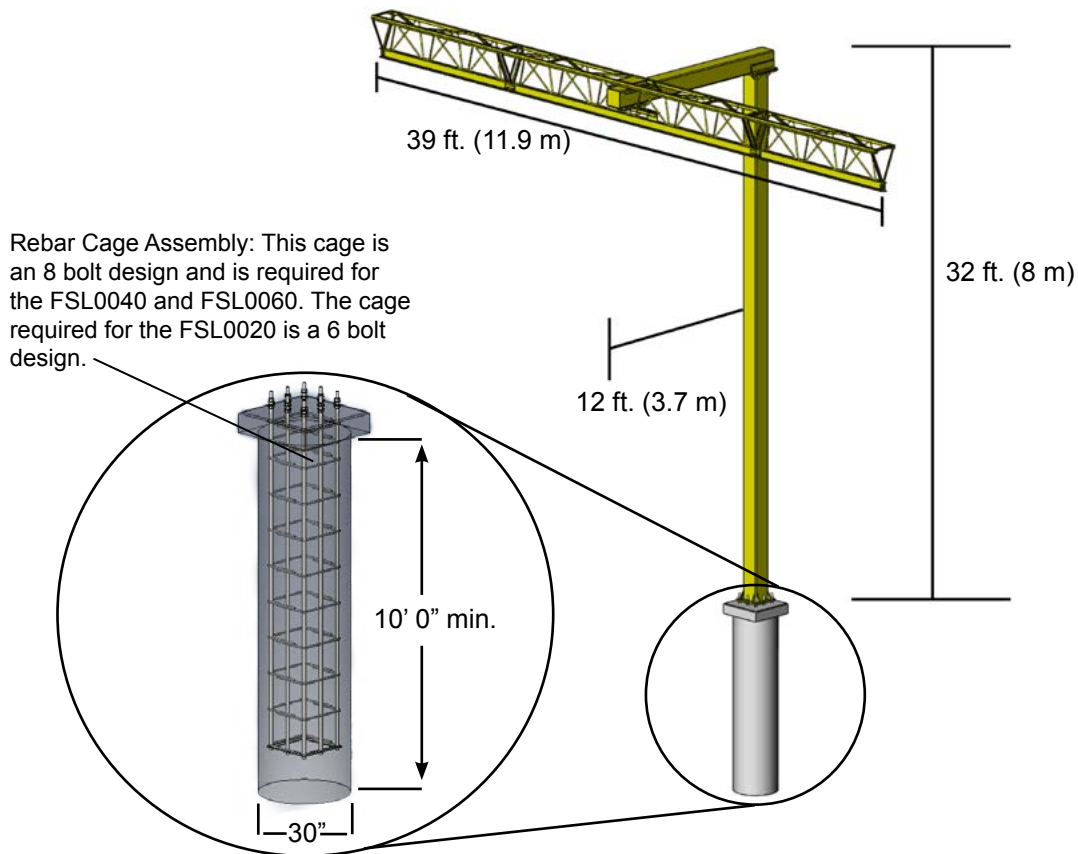

Total System Weight for FSL0040: 3,336 lbs. (1.5 t)



by Honeywell

Toll Free 800.873.5242 (press 4) • hsptechsupport@honeywell.com • www.millerfallprotection.com

WARNING! THIS DOCUMENT PROVIDES AN OVERVIEW OF FALL PROTECTION PRODUCTS AVAILABLE FROM HONEYWELL AND CARE HAS BEEN TAKEN TO ASSURE THE ACCURACY OF THE DATA. IT DOES NOT PROVIDE IMPORTANT PRODUCT WARNINGS AND INSTRUCTIONS. HONEYWELL RECOMMENDS ALL USERS OF FALL PROTECTION EQUIPMENT UNDERGO THOROUGH TRAINING, AND THAT ALL WARNINGS AND INSTRUCTIONS PROVIDED WITH THE PRODUCTS BE THOROUGHLY READ AND UNDERSTOOD PRIOR TO EACH USE. FAILURE TO READ AND FOLLOW ALL PRODUCT WARNINGS AND INSTRUCTIONS COULD RESULT IN SERIOUS INJURY OR DEATH.